

**TOWN OF STRATFORD  
PURCHASING DEPARTMENT  
STRATFORD, CONNECTICUT**

**BID No. 2016-035**

**Issued : July 14th, 2016**

**Subject : Type II "Sprinter" Type Ambulance**

The Town of Stratford through the Office of the Purchasing Agent, will receive SEALED BIDS for Furnishing the equipment described in the accompanying specifications, in accordance with the Instructions, conditions and reservations that follow:

**A. CLOSING DATE:**

Bids will be received until 11:00 am on July 29th, 2016, at which time they will be publicly opened and read. All bidders are invited to attend this public opening, which will be held Immediately following the closing time specified above, in the Office of the Purchasing Agent, Room 202, Town Hall, 2725 Main Street, Stratford, CT 06615.

Any bid may be withdrawn prior to the above-scheduled time for receiving bids or authorized postponement thereof. Any bids received after the date and time specified shall NOT be considered. No bidder may withdraw a bid within 45 days after the actual opening thereof.

**B. INSTRUCTIONS:**

Bid proposals are to be submitted (THREE COPIES) in a sealed envelope and clearly marked with the bid number and description on the outside of the envelope, including all outer packaging (DHL, FedEx, UPS, etc).

Bids must be delivered to:

Purchasing Department  
Stratford Town Hall - Rm 202  
2725 Main Street  
Stratford, CT 06615

### **C. CONDITIONS:**

#### **Bid Surety:**

A Certified Check, Cashiers Check or Bid Bond in the amount of \$5,000.00 must accompany each proposal, made payable to the Town of Stratford. No bid will be considered without this surety. Upon award or rejection of the bid, all Certified Checks or Cashier's Checks received in lieu of Bid Bonds will be returned to the bidders.

**Payment:** Final payment will be made upon the acceptance of the completed work by an authorized representative of the Town of Stratford. NO partial payments will be made. Invoices covering the work specified herein should be forwarded to the Purchasing Department upon completion of the project.

**Taxes:** The Town of Stratford is exempt from all State and Federal taxes. Do not include these amounts in your quotation.

**Addendums:** All addendums will be posted on the town website, [www.townofstratford.com](http://www.townofstratford.com). It is the responsibility of the bidder to check the website for any addendums before submitting their bid. F.O.B. Destination: All prices quoted must be net delivered to destination.

**Conflict of Interest:** No public official or employee shall, while serving as such, have any financial interest or engage in any business, employment, transaction or professional activity or incur any obligation of any nature which is in substantial conflict with the proper discharge of his/her duties or employment in the public interest.

### **D. RESERVATIONS:**

The Town of Stratford may consider informal any bid not prepared and submitted to the Town in accordance with the provisions herein stated. The Town of Stratford reserves the right to reject any or all bids or parts of bids; to waive defects in same bids; or to accept any bid or part thereof deemed to be in the best interests of the Town of Stratford.

---

Michael Bonnar, Purchasing Agent

**STRATFORD EMERGENCY MEDICAL SERVICE**

**AMBULANCE SPECIFICATIONS - BID #2016-035**

The ambulance shall meet or exceed the current Federal G.S.A. KKK-A-1822 specifications.

Bidder Complies YES \_\_\_\_\_ NO \_\_\_\_\_

**CHASSIS MAKE:** The chassis shall be mounted on a commercially available Mercedes Sprinter 144” Wheelbase High Top Sprinter Van 2500 Series manufactured by Mercedes Benz. The chassis manufacturer shall be the vehicle's point of origin. The chassis shall be supplied by Mercedes as an incomplete vehicle to the successful Ambulance manufacturer. The chassis supplied shall conform to all applicable Federal Motor Vehicle Safety Standards in force at the time of manufacturer.

Bidder Complies YES \_\_\_\_\_ NO \_\_\_\_\_

**CHASSIS MODEL:** The chassis shall be a 2017 Mercedes Sprinter 144” Wheelbase High Top Sprinter Van 2500 Series. Vendors must submit line item with chassis options included in submission.

Bidder Complies YES \_\_\_\_\_ NO \_\_\_\_\_

**ENGINE:** A V-6, Turbo-charged Diesel engine shall be provided with a minimum displacement of 3.0 liters 154 horsepower at 3400 revolutions per minute with 280 foot pounds of torque at 1200 revolutions per minute. Engine performance shall comply with or exceed the most current revision of KKK-A-1822.

Bidder Complies YES \_\_\_\_\_ NO \_\_\_\_\_

**TRANSMISSION:** A 5-Speed Automatic, Heavy Duty, Electronically Controlled with overdrive, tow/haul mode and internal transmission oil cooler.

Bidder Complies YES \_\_\_\_\_ NO \_\_\_\_\_

**ALTERNATORS - CHARGING SYSTEM:** A minimum of single alternator option shall be supplied and installed. Must meet or exceed G.S.A. KKK-A-1822 specifications.

Bidder Complies YES \_\_\_\_\_ NO \_\_\_\_\_

**BRAKES:** 4-wheel anti-lock, power assisted hydraulic brakes shall be supplied. The parking brake shall be an independent mechanical driveline brake, provided by the O.E.M.

Bidder Complies YES \_\_\_\_\_ NO \_\_\_\_\_

**FUEL TANK:** A midship fuel tank shall be supplied with a minimum 25 US gallon capacity. The fuel range shall be at least 250 miles per KKK-A-1822.

Bidder Complies YES \_\_\_\_\_ NO \_\_\_\_\_

**SIDE REAR VIEW MIRRORS:** Dual O.E.M. mirrors with power adjusted mirror glass. Both mirrors shall feature a bi-directional breakaway function to permit folding the mirror heads against body in close quarters. If a heated mirror option is available, bidder must specify.

Bidder Complies YES \_\_\_\_\_ NO \_\_\_\_\_

**POWER WINDOWS:** The cab doors shall have power windows.

Bidder Complies YES \_\_\_\_\_ NO \_\_\_\_\_

**DOOR LOCKS:** The chassis shall have power door locks. A manual lock release shall be installed under hood.

Bidder Complies YES \_\_\_\_\_ NO \_\_\_\_\_

**CAB SEATS:** Mercedes Sprinter 2500 O.E.M. Seats

Bidder Complies YES \_\_\_\_\_ NO \_\_\_\_\_

**OCCUPANT RESTRAINT SYSTEM:** The front, forward facing cab seats shall be equipped with installed three-point seat belts. The seat belts shall have pretensioners built into the seatbelt assembly to take up belt slack during a frontal collision. Replace OEM Seatbelts with Orange Color Seatbelts.

Bidder Complies YES \_\_\_\_\_ NO \_\_\_\_\_

**SEAT BELT ANCHORAGE:** Three sets of seat belts are required along the squad bench.

Bidder Complies YES \_\_\_\_\_ NO \_\_\_\_\_

**SUPPLEMENTAL RESTRAINT SYSTEM:** Airbags shall be installed, one on the driver and one on the passenger side.

Bidder Complies YES \_\_\_\_\_ NO \_\_\_\_\_

**CAB STEREO:** An AM/FM CD player in dash radio with auxiliary input shall be included with the chassis.

Bidder Complies YES \_\_\_\_\_ NO \_\_\_\_\_

**CAB FLOOR COVERING:** The cab floor shall be covered with a rubber molded surface.

Bidder Complies YES \_\_\_\_\_ NO \_\_\_\_\_

**TIRES/WHEELS:** O.E.M. All Season Tires

Bidder Complies YES \_\_\_\_\_ NO \_\_\_\_\_

**VEHICLE HEADROOM:** The usable interior vehicle headroom from the floor to the ceiling in the patient area shall be at least 66" in height, and meet or exceed the current Federal G.S.A. KKK-A-1822

Bidder Complies YES \_\_\_\_\_ NO \_\_\_\_\_

**FLOOR LENGTH:** The usable interior vehicle floor length from the rear doors to the bulkhead shall be at least 131" in length or meet or exceed the current Federal G.S.A. KKK-A-1822.

Bidder Complies YES \_\_\_\_\_ NO \_\_\_\_\_

**WELD QUALITY:** All welds within the ambulance shall meet American Welding Society codes for structural and sheet welding. All weld sites shall be cleaned prior to welding. All welds shall be free of cracks, cavitation's, oxidation and foreign substances. Welders employed to weld on the body shall be certified to AWS QC7-93.

Bidder Complies YES \_\_\_\_\_ NO \_\_\_\_\_

**OXYGEN RACK BOLT PLATE:** The oxygen cylinder anchorage system shall meet National Truck Equipment Associations (N.T.E.A), Ambulance Manufacturers Division (AMD) Test No 003. Oxygen storage cabinet shall accommodate an Aluminum M cylinder. Manufacturer shall provide details for an easy loadable / unloadable oxygen tank accessible from the passenger side patient area from underneath the captain's seat/storage area.

Bidder Complies YES \_\_\_\_\_ NO \_\_\_\_\_

**OXYGEN SOLENOID:** Manufacturer provides an oxygen regulator that meets or exceeds current Federal G.S.A. KKK-A-1822 specifications. Vehicle will have electrical oxygen system solenoid which will be wired to on/off of the vehicles module power. A manual override with a time delay not exceeding 15 minutes will be installed. The location of the override will be discussed with a location determined by the customer upon confirmation.

Bidder Complies YES \_\_\_\_\_ NO \_\_\_\_\_

**FRONT MUD FLAPS:** Mud flaps shall be mounted to the front fenders just behind the front tires.

Bidder Complies YES \_\_\_\_\_ NO \_\_\_\_\_

**REAR MUD FLAPS:** Mud flaps behind both rear tires shall be supplied and installed.

Bidder Complies YES \_\_\_\_\_ NO \_\_\_\_\_

**CAB DOME LIGHT:** There shall be a LED dome light in the cab ceiling. The light shall have its own switch on the lens with a toggle between red & white & off option. The light shall be located over the driver.

Bidder Complies YES \_\_\_\_\_ NO \_\_\_\_\_

**CAB DOME LIGHT:** There shall be a LED dome light in the cab ceiling. The light shall have its own switch on the lens with a toggle between red, white & off option. The light shall be located over the passenger.

Bidder Complies YES \_\_\_\_\_ NO \_\_\_\_\_

**THIRD BRAKE LIGHT:** A third brake light, 500 LED, shall be located centered above the rear access doors, and come on only when the brake is applied.

Bidder Complies YES \_\_\_\_\_ NO \_\_\_\_\_

## **EXTERIOR FLOOD and LOAD LIGHTING**

**LEFT SCENE LIGHTS:** Two (2) scene lights shall be provided on the left side of the van top. The lights shall be Whelen 700 LED, with downward illumination. The lense shall be clear, the LED color shall be white. The scene light group shall meet or exceed the current Federal G.S.A. KKK-A-1822 specifications.

Bidder Complies YES \_\_\_\_\_ NO \_\_\_\_\_

**RIGHT SCENE LIGHTS:** Two (2) scene lights shall be provided on the right side of the van top. The lights shall be Whelen 700 LED, with downward illumination. The lense shall be clear, the LED color shall be white. The scene light group shall meet or exceed the current Federal G.S.A. KKK-A-1822 specifications.

Bidder Complies YES \_\_\_\_\_ NO \_\_\_\_\_

**SCENE LIGHT SWITCHING:** The scene lights shall come on with two (2) separate rocker switches, located in the center cab console. One switch labeled "Right Flood" shall control both scene lights on the right side of the body and the other switch labeled "Left Flood" shall control both scene lights on the left side of the body. The right (curb side) scene lights shall also come on when the side entry door is opened.

Bidder Complies YES \_\_\_\_\_ NO \_\_\_\_\_

**REAR LOAD LIGHTS:** Two (2) load lights shall be provided on the rear of the van. The lights shall be Whelen 700 LED, with downward illumination. The scene light group shall meet or exceed meet or exceed the current Federal G.S.A. KKK-A-1822 specifications.

Bidder Complies YES \_\_\_\_\_ NO \_\_\_\_\_

**REAR LOAD LIGHT SWITCHING:** The rear load lights shall come on with a separate rocker switch located in the center cab console. The switch shall be labeled "Rear Flood" shall control both rear load lights on the rear of the body and above the rear access doors. The rear load lights AND rear scene lights on the driver and passenger side shall illuminate when the vehicle is placed in REVERSE. The rear load lights shall also come on when the rear entry door is opened. The scene light group shall meet or exceed meet or exceed the current Federal G.S.A. KKK-A-1822 specifications.

Bidder Complies YES \_\_\_\_\_ NO \_\_\_\_\_

**FRONT HVAC:** The driver cabin shall feature an installed air conditioning, heating and ventilation system. The system shall feature variable heat/cooling control, a fan speed selector switch and discharge air control.

Bidder Complies YES \_\_\_\_\_ NO \_\_\_\_\_

**A/C CONDENSER:** The module AC system shall employ the condenser.

Bidder Complies YES \_\_\_\_\_ NO \_\_\_\_\_

**AIR CONDITIONING EVAPORATOR:** AC/Heat Unit shall have a dual blower motor driven, high output fan. The Vehicle AC/Heater system shall meet or exceed the current Federal G.S.A. KKK-A-1822 specifications.

Bidder Complies YES \_\_\_\_\_ NO \_\_\_\_\_

**CONDENSATION DRAIN PAN:** A condensation pan shall be provided to collect water condensation from the evaporator coil.

Bidder Complies YES \_\_\_\_\_ NO \_\_\_\_\_

**AIR CONDITIONING HOSES:** All A/C Hoses shall meet Society of Automotive Engineers (SAE) J-2064.

Bidder Complies YES \_\_\_\_\_ NO \_\_\_\_\_

**CEILING, REAR AC & HEAT SYSTEM AND THERMOSTAT:** Ceiling channeled and ducted fully pressure regulated Heat/AC System with a minimum of (7) fully adjustable outlets running the full length of the patient compartment ceiling shall be used. AC CLIMATE CONTROL **ELECTRONIC THERMOSTAT** in the action area shall control the air conditioning and heat for the patient cabin.

Bidder Complies YES \_\_\_\_\_ NO \_\_\_\_\_

**RECHARGEABLE FLASHLIGHTS:** Two (2) Knucklehead HAZ-LO LED Spot Model, (Orange) rechargeable flash lights shall be supplied and installed by the ambulance manufacturer. Flashlight chargers will also be installed and wired to the vehicle's electrical system. The customer shall determine location for the lights at confirmation.

Bidder Complies YES \_\_\_\_\_ NO \_\_\_\_\_

**PATIENT CABIN DOME LIGHTS:** The patient compartment shall be provided with a minimum of six (6) kinequip overhead LED "dual-intensity" lights; 3 streetside, and 3 curbside. These lights shall be mounted into the patient compartment headliner and shall not protrude into the patient compartment. The dome lights will have a white trim and a red/white option. The dome lights and configuration shall meet or exceed the current Federal G.S.A. KKK-A-1822 specifications.

Bidder Complies YES \_\_\_\_\_ NO \_\_\_\_\_

**REAR LIGHT TIMER:** (2) Two - A variable, spring wound, mechanical timer switch shall provide temporary illumination of the patient cabin for check out purposes. The switch shall activate the high side of the street side bank of domes. The switch input shall be wired directly to the vehicle batteries. The timer circuit shall meet or exceed the current Federal G.S.A. KKK-A-1822 specifications. The customer shall determine location for the timers at confirmation.

Bidder Complies YES \_\_\_\_\_ NO \_\_\_\_\_

**I.V. BAG HANGING HARDWARE:** Three (2) recessed I.V. Hook assemblies shall be installed in the ceiling. Location of the IV hangers shall be determined by the customer at confirmation.

Bidder Complies YES \_\_\_\_\_ NO \_\_\_\_\_

**OVER HEAD ASSIST RAIL:** One (1) 72" long rail shall be recessed and naturally accessible to assist working attendants in maintaining their balance. The rails shall meet or exceed federal specification KKK-A-1822.

Bidder Complies YES \_\_\_\_\_ NO \_\_\_\_\_

**PATIENT CABIN INSULATION:** Shall meet or exceed current Federal G.S.A. KKK-A-1822 specifications.

Bidder Complies YES \_\_\_\_\_ NO \_\_\_\_\_

**FRONT LIGHT BAR:** The front light bar shall be a Multi-Tiered Fully Enclosed Lightbar with the following functions and settings. Lightbar will function with the Primary and Secondary Lights set to the "On" position. Lightbar & Lights shall meet KKK-A-1822 specifications. Lights shall include a Minimum of (1) Whelen M-2 Red Programmable LED - Flash Pattern #5, (1) Whelen M6 Red Non Programmable LED no lens. Whelen RotoBeam LED All RED. Whelen M6 White Non Programmable LED, no lens IATS \$186.00 (1) Whelen M6 White Non Programmable LED, no lens Center std , (1) Whelen RotoBeam LED all RED - Flash pattern #14. (1) Whelen M6 Red Non Programmable LED, no lens std, (1) Whelen M-2 Red Programmable LED Flash Pattern #5, (1) Lower Whelen M4 Red LED Programmable no lens Flash Pattern #9, (1) Lower Whelen M4 White LED Programmable no lens Flash Pattern #10, (1) Lower Whelen M4 Red LED Programmable no lens Flash Pattern #9, (1) Lower Whelen M4 White LED Programmable no lens Flash Pattern #10, (1) Lower Whelen M4 Red LED Programmable no lens Flash Pattern #9, (1) Lower Whelen M4 White LED Programmable no lens Flash Pattern #10 ,(1) Lower Whelen M4 Red LED Programmable no lens Flash Pattern #9.

Bidder Complies YES \_\_\_\_\_ NO \_\_\_\_\_

**WARNING LIGHT SYSTEM:** The warning light system shall include a Whelen Flasher 1660, Super LED, supplied and installed. The warning lights shall flash in the sequence, and meet or exceed the current Federal G.S.A. KKK-A-1822 specifications. The warning light system shall be controlled with a switch located in the cab console. The switch shall have a "Off" position, "Primary" position, and a "Secondary" position.

Bidder Complies YES \_\_\_\_\_ NO \_\_\_\_\_

**Four (4) Grille Lights:** Whelen Ion, LED. The LED shall be RED in color. The lens shall be CLEAR in color.

Bidder Complies YES \_\_\_\_\_ NO \_\_\_\_\_

**Flange Package:** All warning lights will have a chrome flange if one is available.

Bidder Complies YES \_\_\_\_\_ NO \_\_\_\_\_

**Two (2) Front Intersection Lights:** Whelen 700, LED (Super LED). The LED shall be RED in color. The lens shall be CLEAR in color.

Bidder Complies YES \_\_\_\_\_ NO \_\_\_\_\_

**Two (2) Rear Intersection Lights:** Whelen 700, LED (Super LED). The LED shall be RED in color. The lens shall be CLEAR in color. One (1) light located over each rear wheel well.

Bidder Complies YES \_\_\_\_\_ NO \_\_\_\_\_

**Four (4) Side Warning Lights:** Whelen 900, (Super LED). The LED shall be RED in color. The lens shall be CLEAR in color.

Bidder Complies YES \_\_\_\_\_ NO \_\_\_\_\_



**Two (2) Rear Warning Lights: Whelen 700, (Super LED).** The LED shall be RED in color. The lens shall be CLEAR in color. One (1) light located in each rear upper outer corner. Warning Lights will have a brake override when the drives brake is engaged.

Bidder Complies YES \_\_\_\_\_ NO \_\_\_\_\_

**Two (2) Rear Center Warning Light:** Whelen 700, (Super LED). The LED shall be AMBER in color. The lens shall be CLEAR in color.

**REAR DOOR LIGHTING:** If vehicle does not meet KKK-A-1822 specifications for emergency lighting with rear doors ajar, manufacturer will include plan including pictures for lighting without increasing the height of the vehicle.

Bidder Complies YES \_\_\_\_\_ NO \_\_\_\_\_

**BATTERY SWITCH:** Paddle style battery switch, located at the side of the front console (siren/radios), this switch powers up and shuts down the CONVERSION only. None of the chassis functions shall be affected. Additionally, an indicator light shall illuminate on the cab console panel when the switch is placed in the "ON" position. The light shall meet or exceed the current Federal G.S.A. KKK-A-1822 specifications.

Bidder Complies YES \_\_\_\_\_ NO \_\_\_\_\_

**AUDIOVOX CAMERA SYSTEM:** The vehicle shall include a single camera backup monitoring system(VCMS140I). The system shall include, but not limited to a 7" color monitor that is mounted within clear view of the driver, but not to obstruct view out the front windshield at eye level. The monitor shall be connected to a camera mounted on the rear of ambulance body to allow the driver to view as they are backing up. Unless otherwise specified, the camera shall be mounted over the rear doors as close to the centerline of the vehicle a possible. The system shall include all the necessary cables and adapters to connect the system together with power as needed. The monitor shall automatically be tied in so that when the vehicle is placed in reverse, it will automatically illuminate the monitor. The monitor controls shall allow for the monitor to be illuminated when the vehicle is in any gear.

Bidder Complies YES \_\_\_\_\_ NO \_\_\_\_\_

**CAB CONSOLE:** Front console will be molded, one piece black in color. The console shall allow sufficient space for the installation of the front control panel(s), siren control warning and/or indicator lights and mobile radio control head(s). The auxiliary power control module shall be installed on the driver's side of the console. A triple notebook slot, with removable dividers shall be included in the cab console area. There will be at minimum (2) USB charging ports capable of a minimum of 2.1A Amps individually. manufacturer will also provide customer a plan to mount a Apple iPad using OEM HINT. (Customer will supply photos of current installation in existing sprinter).

Bidder Complies YES \_\_\_\_\_ NO \_\_\_\_\_

**SWITCH PANEL, CAB CONSOLE:** A front console shall be installed to house the switching panel and radio installation. The console shall contain all required switching and accommodate additional spare switches on a VX1 - Class 1 Series Electric System. The console shall be easily serviced through an access panel. Must meet or exceed KKK-A-1822 specifications.

Bidder Complies YES \_\_\_\_\_ NO \_\_\_\_\_

**LOW VOLTAGE INDICATOR:** There will be an amber indicator light in the cab console to illuminate if the vehicle voltage drops.

Bidder Complies YES \_\_\_\_\_ NO \_\_\_\_\_

**DOOR AJAR INDICATOR LIGHT:** A back lighted "Door Ajar" light shall be engraved in the cab console's main switch panel. The light shall meet or exceed the current Federal G.S.A. KKK-A-1822 specifications.

Bidder Complies YES \_\_\_\_\_ NO \_\_\_\_\_

**ELECTRONIC SIREN:** A Whelen WS295SLSA1 Siren, with dual amplifiers. Siren head shall be mounted in center console. A switch shall select horn ring output to horn or siren. The switch shall be located in the cab console's switch panel. The switch legend that clearly defines the switch function shall be engraved in the switch panel. The legend shall be illuminated when the head light switch is on.

Bidder Complies YES \_\_\_\_\_ NO \_\_\_\_\_

**BACK UP ALARM:** The vehicle shall include a 97 to 107 decibel back up alarm, activated by Shifting into reverse. The back up alarm shall have a cut off switch programmed into the cab console to silence the alarm.

Bidder Complies YES \_\_\_\_\_ NO \_\_\_\_\_

**12 VOLT POWER INVERTER:** A highly reliable electronic power conversion unit that utilizes power semi-conductors and a microprocessor controller shall be supplied, installed and wired. The device shall be certified by Underwriters laboratories, and meet or exceed the current Federal G.S.A. KKK-A-1822 specifications, with built-in Battery Charger. This device will have an ignition sense to automatically power on and off. Inverter will be powered when vehicle is plugged in via shoreline.

Bidder Complies YES \_\_\_\_\_ NO \_\_\_\_\_

**12 VDC POWER SOURCE FOR PORTABLE EQUIPMENT:** Positive and Negative polarity fourteen gauge wires shall be supplied and installed for subsequent storage of portable equipment.

Bidder Complies YES \_\_\_\_\_ NO \_\_\_\_\_

**RADIOS:** One (1) Motorola CDM1250 UHF shall be provided by the customer and installed by the manufacturer (Radio 1). (1) Motorola XTL5000 UHF, model # M20SSS9PW1AN, minimum flashcode of 500200-100804-3 with Remote Head Option and 3 control heads units including all necessary cables and speakers will be provided and installed by the manufacturer (Radio 2). Radio 1 shall be installed in the cab center console using Havis equipment bracket part # C-EB30-CDS-1P. The radio chassis for Radio 2 shall be installed in the center console secured using OEM Motorola trundle. One (1) control head shall be installed in the cab center console below Radio 1 using Havis equipment bracket part # C-EB25-XTL-1P. One (1) speaker shall be installed in the cab center console. One (1) control head and one (1) speaker shall be mounted in the action area. One (1) control head and one (1) speaker shall be mounted adjacent to the curbside switch panel in the patient compartment. Control head cables shall be run from the radio chassis to the cab center console control head, from the radio chassis to the action area control head, and from the action area control head to the patient compartment curbside control head. Final locations will be determined by the customer upon confirmation.

Bidder Complies YES \_\_\_\_\_ NO \_\_\_\_\_

**UHF ANTENNA & POWER SOURCE FOR COMMUNICATION RADIO(S):** Four (4) sets of Positive and Negative polarity ten gauge wires and ignition sense wires shall be supplied and installed for installation of communications radio(s) and run to three (3) locations. The ignition sense will be powered on the main battery switch circuit. Two (2) sets of wires shall be run to the center console to power Radio 1 and Radio 2/control head. One (1) set of wires shall be run to the action area to power the action area control head. One (1) set of wires shall be run to the patient compartment curbside control head. The wires shall be barreled off and protected by a thirty (30) ampere automatic reset circuit breaker. There will be two (2) UHF 1/4 wave NMO mount antennas installed by the manufacturer to the roof of the ambulance with coaxial cable run to the cab center console. Final locations will be determined and approved by the customer upon confirmation.

Bidder Complies YES \_\_\_\_\_ NO \_\_\_\_\_

**115 VOLT AC - SHORE-LINE SYSTEM**

**SHORE LINE INLET:** The primary 115 Volt shoreline inlet, rated at 20 Amperes shall be supplied. The inlet shall automatically eject the shoreline connector when the vehicle ignition switch is placed in the START position. The inlet shall be protected with a weatherproof cover. and color shall be "Yellow"

Bidder Complies YES \_\_\_\_\_ NO \_\_\_\_\_

**INTERIOR 125 Volt Alternating Current (AC) OUTLETS:**

**115 VOLT AC OUTLETS:** The following outlets shall be UL listed, 125 Volt, Hospital grade with Dual USB Support (minimum 2.1a output) .A minimum of (6) six 115 VAC Outlets shall be installed. Locations will be identical to existing Sprinter ambulance, customer will supply photos.

Bidder Complies YES \_\_\_\_\_ NO \_\_\_\_\_

**INTERIOR 12 Volt Direct Current (DC) OUTLETS:**

**12 VOLT OUTLET No 1:** This outlet shall be a, 12 volt, direct current, 20 Ampere, automotive "cigar" lighter size commercial outlet. This outlet shall be wired to meet or exceed the current Federal G.S.A. KKK-A-1822 specifications.

**OUTLET LOCATION:** This 12 Volt outlet shall be located in the patient cabin's main "Action

Area" panel. **POWER SOURCE:** The input for the aforementioned outlet shall be wired to the output of the MAIN CONVERSION power switch.

Bidder Complies YES \_\_\_\_\_ NO \_\_\_\_\_

**12 VOLT OUTLET No 2:** This outlet shall be a, 12 volt, direct current, 20 Ampere, automotive "cigar" lighter size commercial outlet. This outlet shall be wired to meet or exceed the current Federal G.S.A. KKK-A-1822 specifications.

**OUTLET LOCATION:** This 12 Volt outlet shall be located in the patient cabin's main "Action Area".

**POWER SOURCE:** The input for the aforementioned outlet shall be wired exactly like outlet Number One.

Bidder Complies YES \_\_\_\_\_ NO \_\_\_\_\_

**ATTENDANT SEAT:** The attendant seat shall be a steel framed, high back bucket style Captain’s chair. The upholstery shall be seamless and vacuum formed. The seat shall be equipped with a 3-point seat belt harness assembly. The seat shall be equipped with a child car seat. The seat shall meet or exceed G.S.A. KKK-A-1822 specifications.

Bidder Complies YES \_\_\_\_\_ NO \_\_\_\_\_

**PARTITION WINDOW:** The driver’s cabin shall be closed off from the patient cabin with a partition. The partition shall be installed with a fixed Lexan window. The window shall include a sliding lexan window. Dimensions will be determined by customer at confirmation and meet or exceed G.S.A. KKK-A-1822 specifications.

Bidder Complies YES \_\_\_\_\_ NO \_\_\_\_\_

**CABINETS/STORAGE: (See Interior Schematic Provided):** Manufacturers will provide layout as included in the interior schematic provided by customer. Any deviations from cabinet/storage layout will require approval of customer and a comparable equivalent schematic provided. Final approval of design will be made by customer at confirmation. Manufacturer will allow for changes to this design during the approval phase.

Bidder Complies YES \_\_\_\_\_ NO \_\_\_\_\_

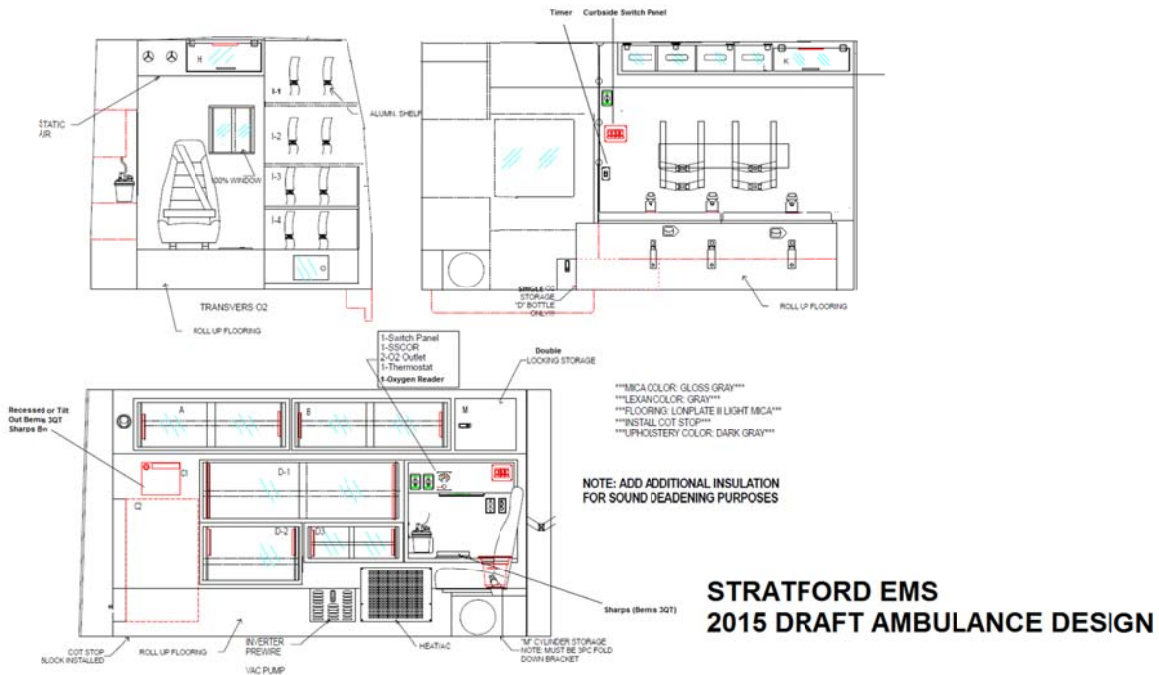

**CABINET LIGHTING:** All cabinets with lexan (marked in red on Interior Schematic) will have toggleable LED lighting on the action and curbside switch panels. Final locations of lighting is determined by customer at confirmation.

Bidder Complies YES \_\_\_\_\_ NO \_\_\_\_\_

**ACTION AREA:** An interior area shall be provided in the forward most mid height-section of the base wall cabinet. In addition to the overhead lighting, a 12 volt DC LED light with integral switch shall be provided in the attendant's work or "action" area. A supplemental Oxygen Gauge will be built in to the action area to enable staff to monitor oxygen pressure readings without accessing the main oxygen compartment.

Bidder Complies YES \_\_\_\_\_ NO \_\_\_\_\_

**CLOCK:** A digital programmable clock shall be installed by the manufacturer at a location determined by the customer at confirmation.

Bidder Complies YES \_\_\_\_\_ NO \_\_\_\_\_

**SQUAD BENCH:** A three-seat squad bench shall be installed. The squad Bench shall meet or exceed the current Federal G.S.A. KKK-A-1822 specifications. A squad bench lid(s) shall be supplied over the squad bench storage area. The lid shall be equipped with a locking device to secure, and preventing accidental opening during a rollover. There shall be a tilt – out garbage can option with location determined by the customer at confirmation. At the head of the squad bench will accommodate (1) “D” size customer supplied oxygen cylinder accessible from the passenger side entry. Bidder will work with customer to make the dimensions of the squad bench as small as possible to accommodate maximum distance to foot of stretcher. Final location for the tilt out garbage and oxygen cylinder must be confirmed by the customer.

Bidder Complies YES \_\_\_\_\_ NO \_\_\_\_\_

**SQUAD BENCH SEAT CUSHIONS:** The seat cushions on the squad bench shall be vacuum formed and seamless. Customer Choice of Colors etc.

Bidder Complies YES \_\_\_\_\_ NO \_\_\_\_\_

**CURBSIDE SEATING AND BELTING:** The Squad Bench shall include two (2) 6-point restraint systems, and three (3) 2-point restraints. There shall also be three (3) female seat belt ends secured the metal bracing on the inside of the squad bench face to allow for securing a secondary patient to the top of the squad bench. The bracket shall be specifically designed to transfer loads originating from a secondary patient.

Bidder Complies YES \_\_\_\_\_ NO \_\_\_\_\_

**FIRE EXTINGUISHER 1:** There shall be an ABS recessed standard 5 pound fire extinguisher so it has easy access from the rear door area. One (1) 5 pound fire extinguisher shall be installed by the manufacturer. Location will be determined by the customer upon confirmation.

Bidder Complies YES \_\_\_\_\_ NO \_\_\_\_\_

**FIRE EXTINGUISHER 2:** One (1) standard 5 pound fire extinguisher shall be installed in cab area by the manufacturer. Location will be determined by the customer upon confirmation.

Bidder Complies YES \_\_\_\_\_ NO \_\_\_\_\_

**RESTRAINT NET:** A restraint net shall be installed from floor to ceiling at the head of the squad bench. The net shall be secured at seven points. All points must be secured to steel braces welded van body structure. The net shall be tightly stretched and attached to the following surfaces. Locations to be determined upon confirmation.

Bidder Complies YES \_\_\_\_\_ NO \_\_\_\_\_

**STAIRCHAIR STORAGE AREA:** An interior area shall be provided in the rear most mid height section of the rear of the ambulance on the street side. Photographs of stair chair and securing straps for safe storage should be included with submission and approved by customer upon confirmation.

Bidder Complies YES \_\_\_\_\_ NO \_\_\_\_\_

**FLOOR COVERING:** The floor substrate shall be free of dents, voids and moisture prior to application of the floor covering. The floor covering shall be one piece throughout the patient cabin. The flooring material shall be commercial grade sheet vinyl floor with diamond plate like impression on the surface. The floor covering shall be Lonseal Lonplate II. A seamless lonplate flooring shall go up the full height of the squad bench to the lid, across the front of the vehicle at an approximate height of 10 inches. Bidder shall submit pictures from another Connecticut Delivered Sprinter 2500 series as proof of supplying the above floor covering.

Bidder Complies YES \_\_\_\_\_ NO \_\_\_\_\_

**REAR THRESHOLD:** The rear threshold shall be a formed minimum 4" Aluminum trim piece with a beveled rear edge to facilitate loading and a floor plate to protect the floor. The threshold shall be finished with yellow & black non-skid tape.

Bidder Complies YES \_\_\_\_\_ NO \_\_\_\_\_

### **OXYGEN, AIR and VACUUM SYSTEMS**

**OXYGEN OUTLET No 1:** This outlet latch shall be designed to accept Ohmeda (Ohio) style, quarter turn / quick release adapters. Manufacturer shall supply A "Precision" style Flowmeter 0-25 lpm with all the appropriate connectors shall be included and connected. LOCATION: The Oxygen outlet shall be located in the primary action area switch and outlet console.

Bidder Complies YES \_\_\_\_\_ NO \_\_\_\_\_

**OXYGEN OUTLET No 2:** This outlet latch shall be designed to accept Ohmeda (Ohio) style, quarter turn / quick release adapters. Manufacturer shall supply A "Precision" style Flowmeter 0-25 lpm with all the appropriate connectors shall be included and connected. LOCATION: The Oxygen outlet shall be located in the primary action area switch and outlet console.

Bidder Complies YES \_\_\_\_\_ NO \_\_\_\_\_

**OXYGEN OUTLET No 3:** This outlet latch shall be designed to accept Ohmeda (Ohio) style, quarter turn / quick release adapters. Manufacturer shall supply A "Precision" style Flowmeter 0-25 lpm with all the appropriate connectors shall be included and connected. LOCATION: The Oxygen outlet shall be located high in curb side wall, over the squad bench and near the curbside entry door.

Bidder Complies YES \_\_\_\_\_ NO \_\_\_\_\_

**VACUUM SYSTEM:** A variable SSCOR vacuum regulator and gauge panel shall be installed in the action area control panel. The vacuum regulator shall vary vacuum delivered to a 1200 cubic centimeter collection jar. The Vacuum gauge shall not be mounted on the collection jar itself.

Bidder Complies YES \_\_\_\_\_ NO \_\_\_\_\_

**SUCTION PUMP:** The suction pump shall be installed in the space under the action area. The pump shall provide a free air flow of at least 20 liters per minute and achieve a minimum of 300mm (11.81 in) Hg vacuum within four seconds after the suction tube is closed.

Bidder Complies YES \_\_\_\_\_ NO \_\_\_\_\_

**AED STORAGE AREA:** Manufacturer and Customer must determine a suitable location to store a Physio Control - Lifepak 1000. Location will be determined upon confirmation.

Bidder Complies YES \_\_\_\_\_ NO \_\_\_\_\_

**DOOR PANELS:** Manufacturer will provide customer option (if available) additional ABS style storage options available. Locations will be determined by customer on confirmation.

Bidder Complies YES \_\_\_\_\_ NO \_\_\_\_\_

**PATIENT AREA INTERIOR HANDLES:** Black rubber coated spring steel handles shall be through bolted to the interior door surface on the interior of each of the four patient entry doors under the window.

Bidder Complies YES \_\_\_\_\_ NO \_\_\_\_\_

**REAR BUMPER:** The Rear Bumper shall include a stepping area that shall comply with the Requirement of stepping height and cot loading requirements meeting or exceeding KKK-A-1822.

Bidder Complies YES \_\_\_\_\_ NO \_\_\_\_\_

**REAR BUMPER TRANSITION STEP:** Secured the rear chassis frame with a minimum of four (4) grade 8 bolts and nuts and constructed of extruded, formed and welded steel shall be a formed aluminum diamond plate step that has a skid resistant pattern punched from the bottom side.

Bidder Complies YES \_\_\_\_\_ NO \_\_\_\_\_

**PATIENT AREA MASTER SWITCH:** A second master switch for the patient area power shall be integrated into the VX1 Class 1 Series into the in the area area switch and one additional control head to the switch located in the cab console as well as the patient squad bench passenger side, location to be determined but the customer upon confirmation.

Bidder Complies YES \_\_\_\_\_ NO \_\_\_\_\_

**PATIENT CABIN VENTILATION:** A power exhaust ventilation blower shall be installed at the rear of the vehicle in a location as high as possible. The exhaust blower used shall move air at a free flow rate of two hundred thirty cubic feet per minute. Control for this fan shall be located in the patient area switch panel located in the action area and meet or exceed the current Federal G.S.A. KKK-A-1822 specifications.

Bidder Complies YES \_\_\_\_\_ NO \_\_\_\_\_

**Power Load System:** Customer will supply (1) one new Stryker Power Load System which will be installed by Manufacturer. Manufacturer assumes shipping costs and will install all the necessary customer components. Manufacturer must be certified and authorized by Stryker Corporation to supply and install all components as required. A Stryker OEM wheel guard will be installed on the driver side floor to aid removal of the stretcher.

Bidder Complies YES \_\_\_\_\_ NO \_\_\_\_\_

**BIOWASTE SYSTEM:** The vehicle shall include (2) two space for two 3-QUART WALLSAFE® SHARPS CONTAINERS. (1) one location shall be in the base of the action area and the second will be recessed into an area on the drivers side near the stair chair storage.

Bidder Complies YES \_\_\_\_\_ NO \_\_\_\_\_

**REFLECTOR PACKAGE:** Manufacturer will submit suitable locations for (6) Whelen OS Marker/Clearance, Illumination and Flash to be fixed to all patient compartment doors that open to provide additional rear warning protection. All lights shall be red. Any additional reflector material must meet or exceed the current Federal G.S.A. KKK-A-1822 specifications.

Bidder Complies YES \_\_\_\_\_ NO \_\_\_\_\_

**UPHOLSTERY MATERIAL:** All padding and upholstered seating shall be covered in 36 ounce vacuum formable vinyl to eliminate visible seams.

Bidder Complies YES \_\_\_\_\_ NO \_\_\_\_\_

**GLOVE HOLDERS:** Minimum 4 glove holders shall be installed on the passenger side above the squad bench. Location determined by customer on confirmation.

Bidder Complies YES \_\_\_\_\_ NO \_\_\_\_\_

**MODEM:** Manufacturer will install a customer Sierra Wireless GX450 Modem designed for the AT&T GSM Network which shall be mounted in the vehicles electrical compartment and wired to a charge guard with time delay . Manufacturer will install a customer supplied Sierra Wireless AP-GX450-MIMO (AP-GX450) Antenna AND GPS Antenna. Manufacturer will run the supplied cable directly to the GX450 modem. Antenna(s) will be bolted the vehicles roof with a waterproof seal and verified to have no leaks.

Bidder Complies YES \_\_\_\_\_ NO \_\_\_\_\_

**VEHICLE MAINTENANCE/SERVICE/REPAIR:** Vehicle maintenance, vehicle service, and vehicle repairs shall be completed within a 20-mile radius of the Purchaser's location which is manufacturer certified .

Bidder Complies YES \_\_\_\_\_ NO \_\_\_\_\_

**PAINT SCHEME AND LETTERING**

**MAIN BODY COLOR:** The main body color shall be white.

Bidder Complies YES \_\_\_\_\_ NO \_\_\_\_\_



**CUSTOM LETTERING AND PAINT LAYOUT:** The lettering and paint shall duplicate the Stratford Emergency Medical Service logo, lettering, layout, and colors – matching and adapted from our 2016 Type II Sprinter ambulance. The DOT package and 32inch Roof Star of Life, blue/white reflective, and two (2) perforated sheets with star of life overlay allowing for one way visibility from the patient compartment outside the rear door windows shall be included. Departments website will be added to the front driver and passenger front doors (customer will supply photo for reference)

Bidder Complies YES \_\_\_\_\_ NO \_\_\_\_\_

**PAST PERFORMANCE:** Manufacturer is requested to provide references of past performance delivering the Sprinter 2500 Series Type II Ambulance. References should include a minimum of (5) different agencies in the State of Connecticut over the last (2) years.

Bidder Complies YES \_\_\_\_\_ NO \_\_\_\_\_

TOWN OF STRATFORD

BID SHEET

BID # 2015-035 DESCRIPTION: Type-II Ambulance

Price for Type-II Ambulance: \_\_\_\_\_

You must provide a detailed description including specifications of everything that is included in the bid. All exceptions and alternate options must be noted and described in detail.

Delivery: \_\_\_\_\_ days after receipt of order

References in at least three other municipalities:

(include contact name and phone)

---

---

---

Bidders Name : \_\_\_\_\_

Address : \_\_\_\_\_

\_\_\_\_\_

Phone : \_\_\_\_\_

Date : \_\_\_\_\_

Authorized Signature : \_\_\_\_\_

Printed Name : \_\_\_\_\_

Title : \_\_\_\_\_