

ADDENDUM 1



Ball Safety Netting System: Penders Field – Long Brook Park

103 Glendale Road
Stratford, CT 06614

TOWN PROJECT NUMBER: 2018-026

DATE: 6/21/2018

PROJECT TEAM

Architect / Project Manager

Engineer

SNYDER
ARCHITECTS, LLC

Architecture . Planning . Construction Management

Trumbull, CT 203-243-3346
info@snyderarchitects.com



MILONE & MACBROOM

99 Realty Drive

*Engineering, Planning,
Landscape Architecture
and Environmental Science*

Cheshire, CT 06410

203-271-1773

The work shall be carried out in accordance with the following supplemental instructions and in accordance with the Contract Documents.

DRAWING CHANGES

Drawing SP-4 – Foundation Detail (for 40' Poles):

- Drawing added

Drawing SP-5 – Foundation Detail (for 60' Poles - Alternate):

- Drawing added

END OF ADDENDUM NO. 1

C:\Users\NIBROSHIP\APPDATA\LOCAL\TEMP\ASPERIBUILD_5508\VF SITE PLAN\DWG Layout_TapsP-4

Plotted by: NIBROSHIP On this date: Thu, 2018 June 28 - 4:56pm

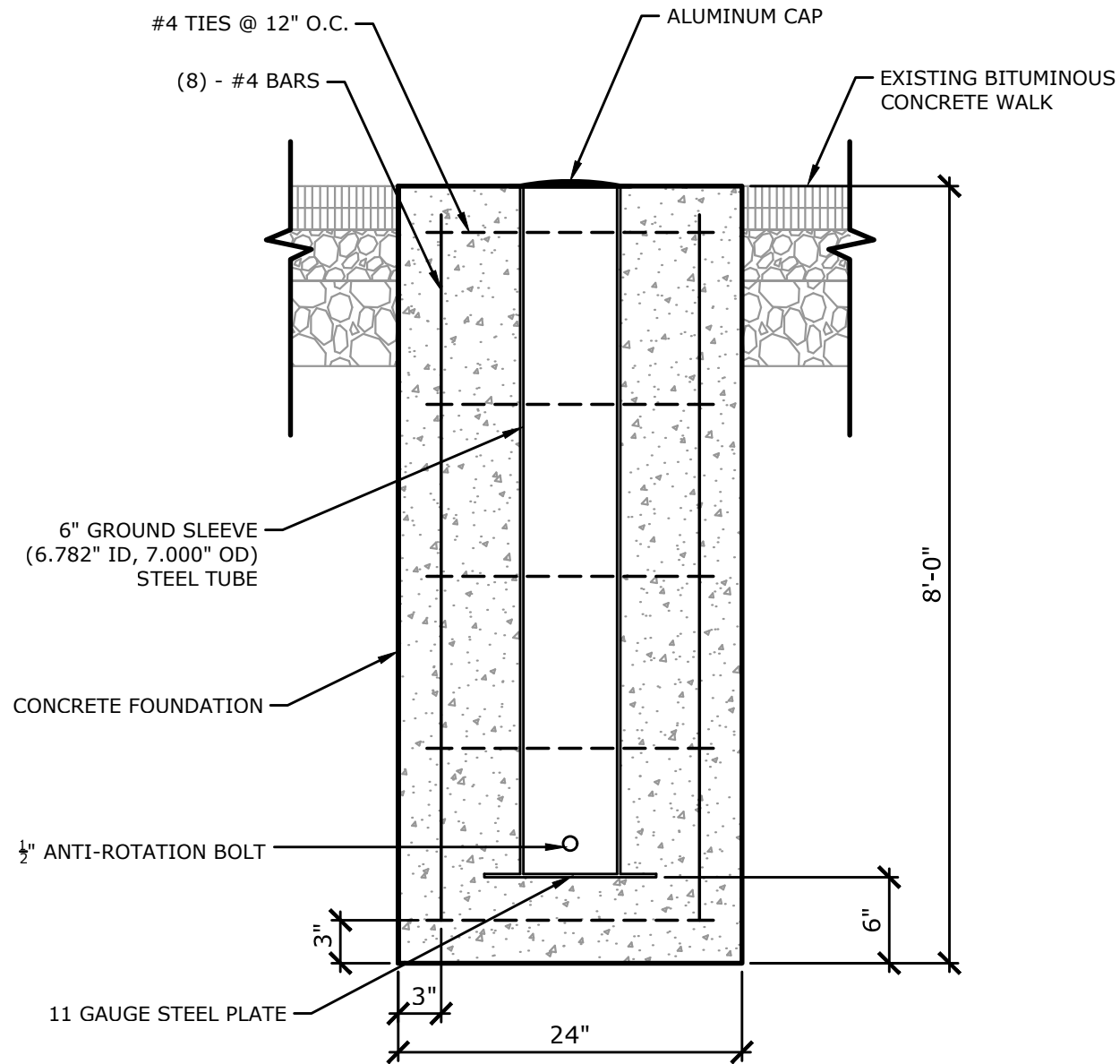

SUPPLY AND INSTALL BALL SAFETY NET SYSTEM AND HARDWARE
 MODEL: BSS640.
 AS MANUFACTURED BY: SPORTSFIELD SPECIALTIES,
 DELHI, NY, 888-975-3343 OR APPROVED EQUAL.

NOTES:

1. SEE SITE PLAN FOR GROUND SLEEVES LOCATIONS. CONFIRM ALL LOCATIONS WITH OWER PRIOR TO INITIATING CONSTRUCTION ACTIVITIES.
2. DETAIL PROVIDED FOR REFERENCE ONLY.
3. CONTRACTOR TO PROVIDE SHOP DRAWING FOR NET POST FOUNDATIONS.
4. FOUNDATION DESIGN SHALL BE SIGNED AND SEALED BY A PROFESSIONAL ENGINEER LICENSED IN THE STATE OF CONNECTICUT.

1 40' BALL SAFETY NET POST FOUNDATION
 NOT TO SCALE

GENERAL NOTES

1. SPECIFICATIONS: CONNECTICUT DEPARTMENT OF TRANSPORTATION FORM 817 (2016), AND SPECIAL PROVISIONS.
2. DESIGN SPECIFICATIONS: AASHTO LRFD DESIGN SPECIFICATIONS, 7TH EDITION WITH 2016 INTERIM REVISIONS, AS SUPPLEMENTED BY THE CONNECTICUT DEPARTMENT OF TRANSPORTATION BRIDGE DESIGN MANUAL (2003).
3. ALLOWABLE DESIGN STRESSES:
 CLASS "F" CONCRETE:
 BASED ON $f'_c = 4,000$ PSI

CONCRETE NOTES

1. REMAIN-IN-PLACE FORMS: THE USE OF REMAIN-IN-PLACE FORMS ON THIS STRUCTURE IS NOT ALLOWED.
2. CLASS "F" CONCRETE: CLASS "F" CONCRETE SHALL BE USED.
3. CONCRETE COVER: ALL REINFORCEMENT SHALL HAVE TWO INCHES OF COVER UNLESS DIMENSIONED OTHERWISE.
4. EXPOSED EDGES: EXPOSED EDGES OF CONCRETE SHALL BE BEVELED 1"x1" UNLESS DIMENSIONED OTHERWISE.
5. REINFORCEMENT: ALL REINFORCEMENT SHALL BE ASTM A615 GRADE 60.
6. EPOXY COATED REINFORCING BARS: ALL REINFORCEMENT WITHIN THE PRECAST SHALL BE EPOXY COATED.

MILONE & MACBROOM

99 Realty Drive
 Cheshire, Connecticut 06410
 (203) 271-1773 Fax (203) 272-9733
 www.miloneandmacbroom.com

REVISIONS

ISSUED FOR BID

FOUNDATION DETAIL - BASE BID

BALL SAFETY NETTING SYSTEMS
 PENDERS FIELD

103 GLENDALE ROAD
 STRATFORD, CONNECTICUT

GJ DESIGNED	KCF DRAWN	VCM CHECKED
SCALE N.T.S.		
DATE 6/27/18		
PROJECT NO. 6485-01		

SP-4



Know what's below.
 Call before you dig.
 www.cbyd.com

Copyright Milone & MacBroom, Inc. - 2018

C:\Users\NIBROSHIP\APPDATA\LOCAL\TEMP\ASPBURSH_5508\VF SITE PLAN\DWG Layout Tab:SP-5

Plotted by: NIBROSHIP On this date: Thu, 2018 June 28 - 4:55pm

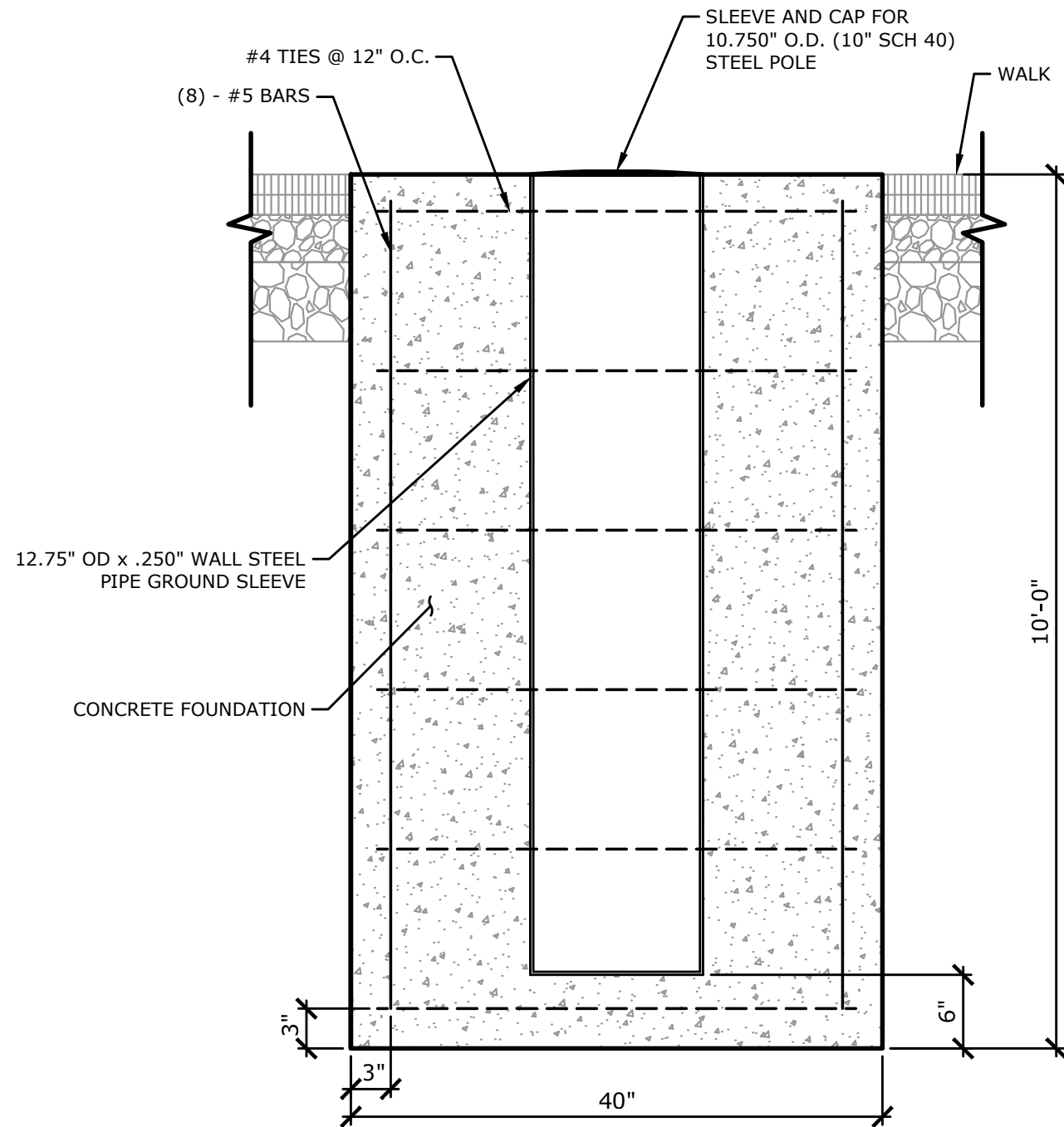

SUPPLY AND INSTALL FOOTBALL NET SYSTEM AND HARDWARE
 MODEL: FSNS106040.
 AS MANUFACTURED BY: SPORTSFIELD SPECIALTIES,
 DELHI, NY, 888-975-3343 OR APPROVED EQUAL.

NOTES:

1. SEE SITE PLAN FOR GROUND SLEEVES LOCATIONS. ALL POST LOCATIONS SHALL BE APPROVED BY OWNER PRIOR TO INITIATING CONSTRUCTION ACTIVITIES.
2. DETAIL PROVIDED FOR REFERENCE ONLY.
3. CONTRACTOR TO PROVIDE SHOP DRAWING FOR BALL SAFETY NET POST FOUNDATIONS.
4. FOUNDATION DESIGN SHALL BE SIGNED AND SEALED BY A PROFESSIONAL ENGINEER LICENSED IN THE STATE OF CONNECTICUT.

GENERAL NOTES

1. SPECIFICATIONS: CONNECTICUT DEPARTMENT OF TRANSPORTATION FORM 817 (2016), AND SPECIAL PROVISIONS.
2. DESIGN SPECIFICATIONS: AASHTO LRFD DESIGN SPECIFICATIONS, 7TH EDITION WITH 2016 INTERIM REVISIONS, AS SUPPLEMENTED BY THE CONNECTICUT DEPARTMENT OF TRANSPORTATION BRIDGE DESIGN MANUAL (2003).
3. ALLOWABLE DESIGN STRESSES:
 CLASS "F" CONCRETE:
 BASED ON $f'_c = 4,000$ PSI

CONCRETE NOTES

1. REMAIN-IN-PLACE FORMS: THE USE OF REMAIN-IN-PLACE FORMS ON THIS STRUCTURE IS NOT ALLOWED.
2. CLASS "F" CONCRETE: CLASS "F" CONCRETE SHALL BE USED.
3. CONCRETE COVER: ALL REINFORCEMENT SHALL HAVE TWO INCHES OF COVER UNLESS DIMENSIONED OTHERWISE.
4. EXPOSED EDGES: EXPOSED EDGES OF CONCRETE SHALL BE BEVELED 1"x1" UNLESS DIMENSIONED OTHERWISE.
5. REINFORCEMENT: ALL REINFORCEMENT SHALL BE ASTM A615 GRADE 60.
6. EPOXY COATED REINFORCING BARS: ALL REINFORCEMENT WITHIN THE PRECAST SHALL BE EPOXY COATED.

1 60` BALL SAFETY NET POST FOUNDATION
 NOT TO SCALE



Know what's below.
 Call before you dig.
 www.cbyd.com

MILONE & MACBROOM

99 Realty Drive
 Cheshire, Connecticut 06410
 (203) 271-1773 Fax (203) 272-9733
 www.miloneandmacbroom.com

REVISIONS

ISSUED FOR BID

FOUNDATION DETAIL - BID ALTERNATE 1

BALL SAFETY NETTING SYSTEMS
 PENDERS FIELD

103 GLENDALE ROAD
 STRATFORD, CONNECTICUT

GJ DESIGNED	KCF DRAWN	VCM CHECKED
SCALE N.T.S.		
DATE 6/27/18		
PROJECT NO. 6485-01		

SP-5

Copyright Milone & MacBroom, Inc. - 2018